

P862CS803JN-HB3-

Price

Lead time

Configuration

Type:	P
Size:	862C
Input:	160 B5 ø350
Output shaft/bore:	ø60
Mounting:	S8
Mounting position:	B3
Input bore:	-
Coupling:	-

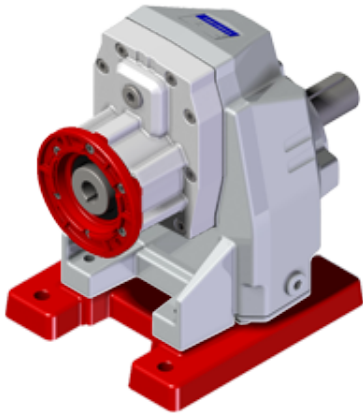

Technical data

Input rpm (n_1):	1400 min⁻¹
Output rpm (n_2):	219.37 min⁻¹
Ratio (i):	6.38 (03)
Nominal power (P_{1R}):	19.14 kW
Nominal torque (M_{2R}):	800 Nm
Dynamic efficiency (RD):	96%

Selection

Motor power (P_{1M}):	15.00 kW
Output torque (M_{2M}):	601 Nm
Service factor (f.s.):	1.3

Direction of rotation

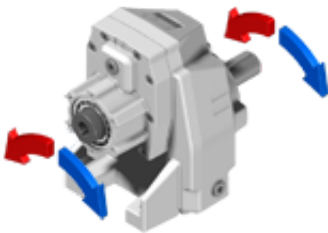

Lubrication

Oil quantity:	Ask
---------------	------------

On our website

Features	Atex certification
How to order	Installation check list
Dimension	Spare parts list
Accessories/options	Complete catalogue
Electric motors	Selection by power (xls)
Selection guide - fs	
Mounting pos. - lubricant	
Calc. the overhung load	

Axial and radial loads

Note

Gearbox weight peso riduttore	With flange	84.0 kg
	With feet	74.5 kg

B14 Motor Flanges	A	C _{max}	g6	k1	kit code
100/112 B14	348.5	260	160	348.5	K085.4.047
132 B14	370	280	200	370	KC51.4.041C
-	-	-	-	-	-