

Input data

System of measurement		Metric
Input type		Coupling for electric motor
Input speed	[rpm]	1400
Output speed	[rpm]	107.28
Ratio (i=)		13.05
Frequency	[Hz]	50
Input options		IEC
Requested input power	[kW]	3
Service factor		2.1
Thermal power	[kW]	5.8

Output data

Gear unit T C 90 B 12.5 100_B5 O B3 H32

Type		T - Bevel helical gearboxes
Input type		C
Size		90B
Ratio (i=)		13.05
Input flange		B5
Mounting position		B3
Input speed	[rpm]	1400
Output speed	[rpm]	107.28
Rated output torque	[Nm]	253.71
Service Factor		2.1
Efficiency		0.95

Gear unit configuration

Output shaft		H32
Fixing		Universal

Electric motor coupling

Size		100 B
Poles n.		4
Power	[kW]	3

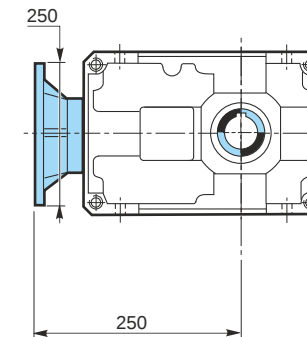
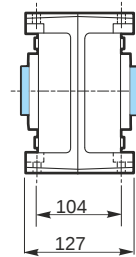
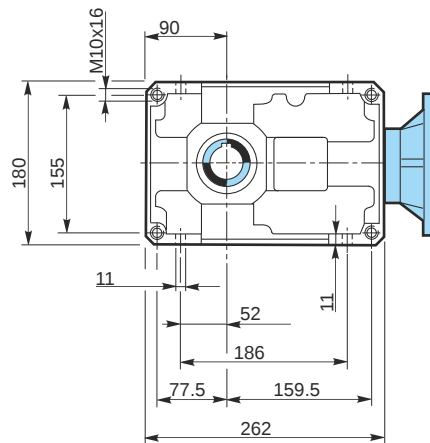

Hollow output shaft

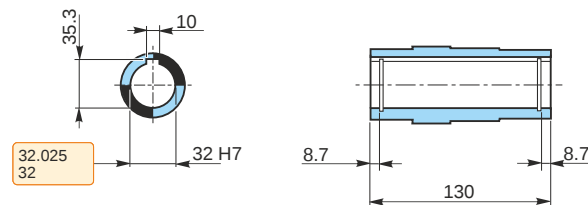

Mounting positions

B3

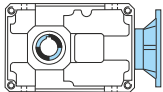

B6



B7

B8

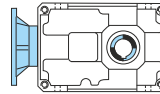

VA

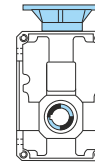

VB

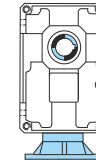

1

1

1.4

1.2

1.3

1.3

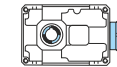

← Oil quantity [litres]

Lubricant type: Long life synthetic oil ISO VG320

Direction of rotation

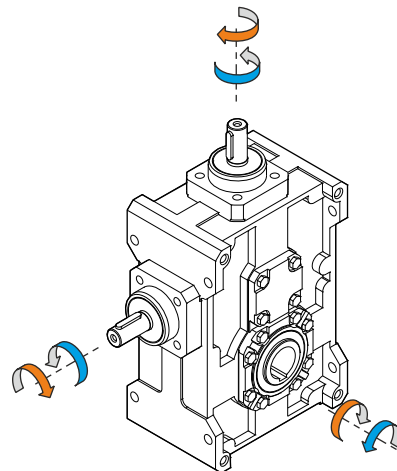

Weight

Gear unit [kg]

25