

## Immersion pumps

Type IMM 40-50



### Usages:

These pumps are suitable for transferring clean liquids containing impurities measuring up to 2-3 mm. The hydraulic components, namely the impeller, scroll and pump body in PBT, allow the pumps to be used with water, emulsions and oily substances with a maximum viscosity of 3° Engler (21 CST).

The temperature of the liquid must not exceed 70° C.

### They are usually used on:

**Machine tools** (milling machines – lathes –drills)

**Glass-processing machines** (TRI version)

**Air-conditioning systems.**

They should usually be installed at on a tank, with a capacity in proportion to the flow rate, at about 2 – 3 cm. from the bottom. It is important to check that the maximum level of the liquid in the tank always remains 3 – 4 cm. lower than the flange (see figure).

In cases where the liquid is particularly dirty, the user is recommended to construct the tank in compartments to allow the dirt to deposit before it is stirred up by the pump.

For other usages you are advised to consult our technical office

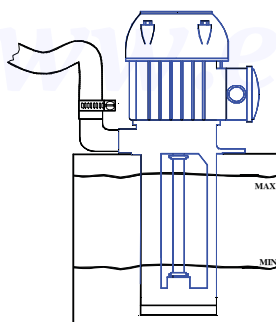
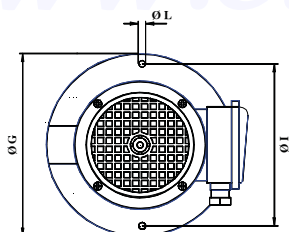
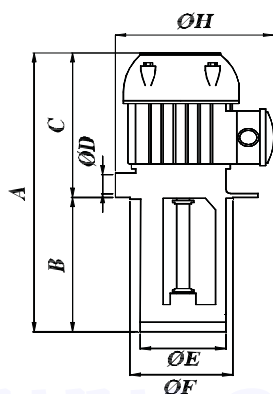
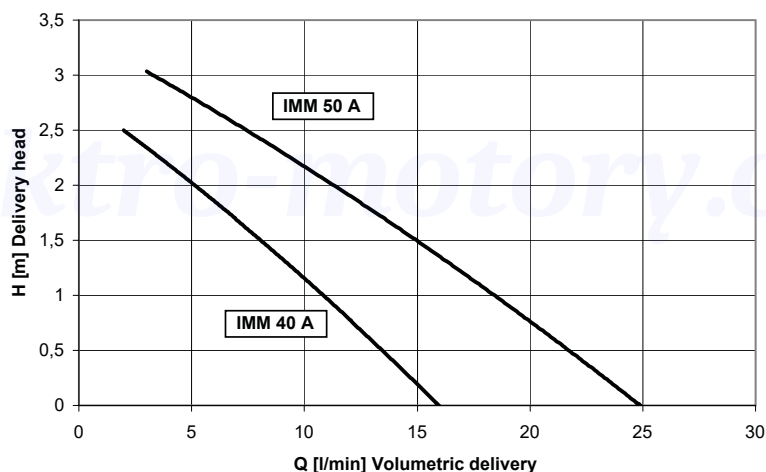

Table of dimesions and weights

TYPE	A mm	B mm	C mm	ØD	ØE mm	ØF mm	ØG mm	H mm	ØI mm	ØL mm	Kg.
IMM 40	224	80	144	3/8"	78	90	130	140	114	7 N. 2	1,8
	264	120									1,83
	294	150									1,85
	324	180									1,88
IMM 50	224	80	144	3/8"	78	90	130	140	114	7 N. 2	1,8
	264	120									1,83
	294	150									1,85
	324	180									1,88

Electrical features

TYPE	KW. Input	Hz. 50		Hz. 60		
		230/400	254-290/440-500	230/400	208-230/440-460	254-277/440-480
IMM 40	0,08	0,4/0,23	0,35/0,21	0,48/0,28	0,43/0,25	0,4/0,23
IMM 50	0,11	0,52/0,3	0,4/0,23	0,6/0,35	0,56/0,32	0,52/0,3



The data of this diagram are referred to a viscosity not higher than 5 CST 20° c

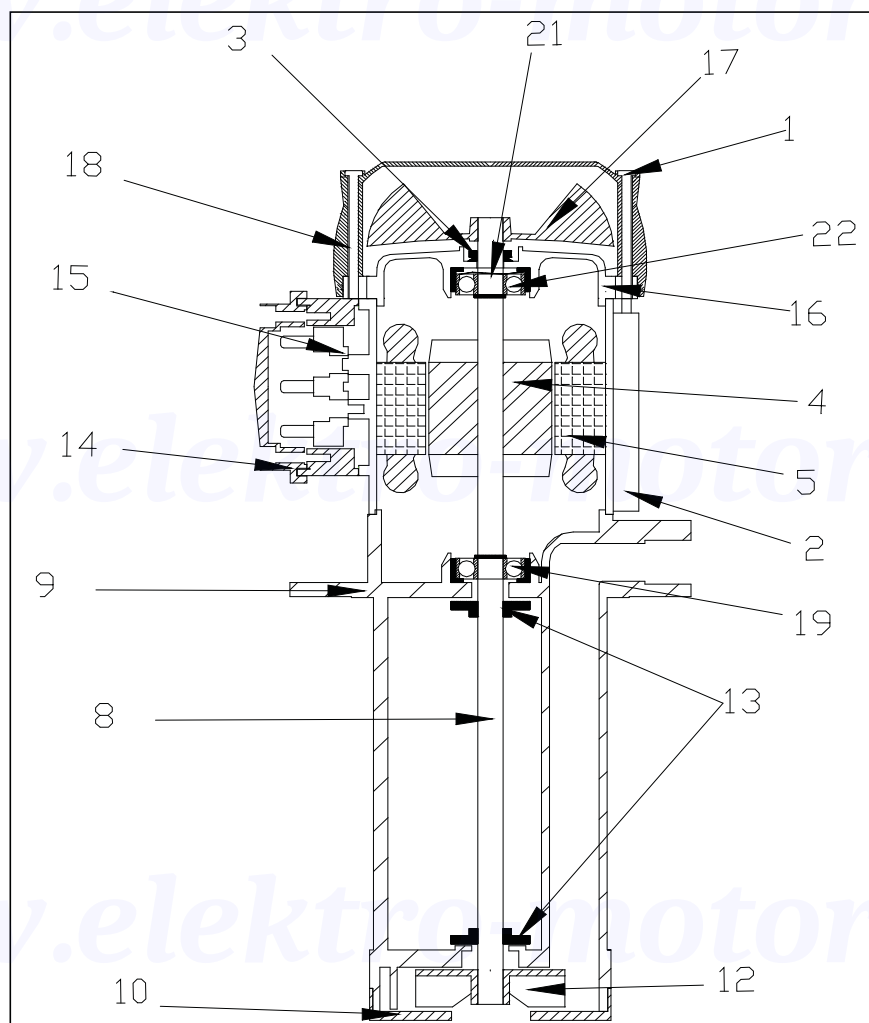

## Type

## IMM 40 A

## IMM 50 A

## Components

## Materials

## Materials

1	Rod
2	Frame
3	V-Ring $\varnothing 8$
4	Rotor
5	Stator
8	Shaft
9	Pump body
10	House impeller
12	Impeller
13	Rubber washer
14	Terminal box
15	Terminal block
16	Non-drive end shield
17	Fan
18	Fan cover
19	Drive end shield
21	Spring ring
22	Bearing

Steel
Aluminium
NBR
Steel C 40**
PBT
PBT
Nylon
PBT
Nylon
mm. 40x25 6P
Nylon
Nylon
Nylon
608 2RS
$\varnothing 22$
608 2RS

Steel
Aluminium
NBR
Steel C 40**
PBT
PBT
Nylon
PBT
Nylon
mm. 40x25 6P
Nylon
Nylon
Nylon
608 2RS
$\varnothing 22$
608 2RS

On request

\*\*

Aisi 303