

P063FB06C0-CB3-

Price

Lead time

Configuration

| | |
|--------------------|--------------|
| Type: | P |
| Size: | 063 |
| Input: | 71 B5 ø160 |
| Output shaft/bore: | Standard ø25 |
| Mounting: | FB |
| Mounting position: | B3 |
| Input bore: | - |
| Coupling: | - |

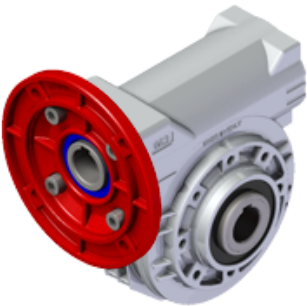

Technical data

| | |
|------------------------------------|-------------------------|
| Input rpm (n ₁): | 1400 min ⁻¹ |
| Output rpm (n ₂): | 46.67 min ⁻¹ |
| Ratio (i): | 30.00 (06) |
| Nominal power (P _{1R}): | 0.96 kW |
| Nominal torque (M _{2R}): | 146 Nm |
| Dynamic efficiency (RD): | 74% |

Selection

| | |
|-----------------------------------|---------|
| Motor power (P _{1M}): | 0.37 kW |
| Output torque (M _{2M}): | 56 Nm |
| Service factor (f.s.): | 2.6 |

Lubrication

| | |
|---------------|-----------------|
| Oil quantity: | 0.40l |
| AGIP: | Telium VSF 320 |
| SHELL: | Omala S4 WE 320 |

Direction of rotation



On our website

| | |
|---------------------------|--------------------------|
| Features | Irreversibility |
| How to order | Thermal limit |
| Dimension | Atex certification |
| Accessories/options | Installation check list |
| Electric motors | Spare parts list |
| Selection guide - fs | Complete catalogue |
| Mounting pos. - lubricant | Selection by power (xls) |
| Calc. the overhung load | |

Axial and radial loads

Input shaft

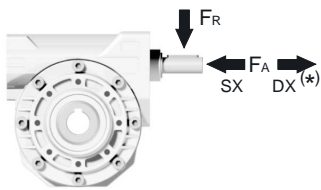

| n ₂ (min ⁻¹) | FA (N) | FR (N) |
|--|-----------|-----------|
| 1400 | 90 | 450 |

*Strong axial loads in the DX direction are not allowed

Output shaft

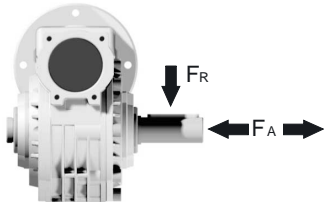

| n ₂ (min ⁻¹) | FA (N) | FR (N) |
|--|-----------|-----------|
| 200 | 360 | 1800 |
| 150 | 400 | 2000 |
| 100 | 460 | 2300 |
| 75 | 500 | 2500 |
| 50 | 600 | 3000 |
| 25 | 700 | 3800 |
| 15 | 800 | 4000 |

Note

P063FB... Basic wormbox
Riduttore base

Gearbox weight
peso riduttore **6.00 kg**

| M. flanges | Kit code | øF | A |
|------------|------------|-----|------|
| 63B5 | K063.4.041 | 140 | 99.5 |
| 71B5 | K063.4.042 | 160 | 97.5 |
| 80/90B5 | K063.4.043 | 200 | 99.5 |
| 71B14 | K063.4.047 | 105 | 97.5 |
| 80B14 | K063.4.046 | 120 | 99.5 |
| 90B14 | K063.4.041 | 140 | 99.5 |

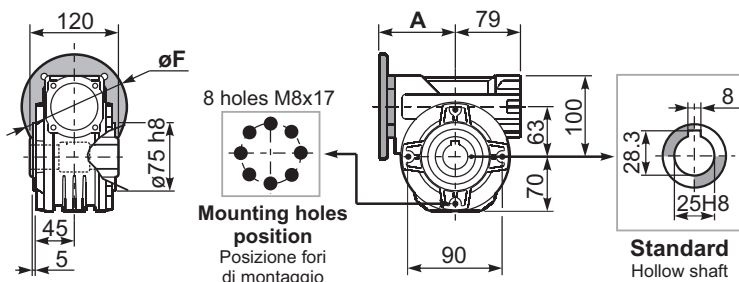

P063PA... Feet
Piedini

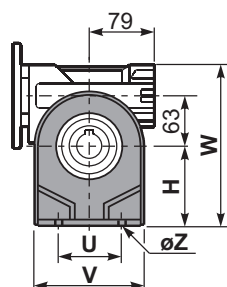
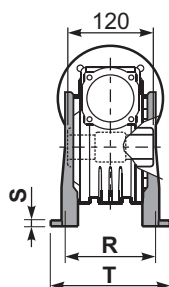

P063PB... Feet
Piedini

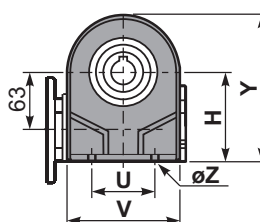

P063PV... Feet
Piedini

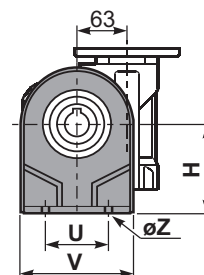

| | H | R | S | T | U | V | Y | W | øZ | kit code |
|--------|-----|-----|---|-----|----|-----|-----|-----|-------|------------|
| type B | 100 | 111 | 4 | 144 | 95 | 133 | 170 | 200 | ø10.5 | K063.9.022 |
| type S | - | - | - | - | - | - | - | - | - | - |

P063FC... Output flange
Flangia uscita

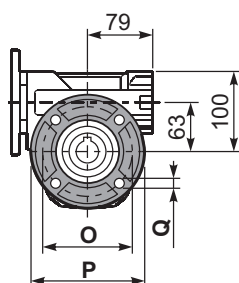
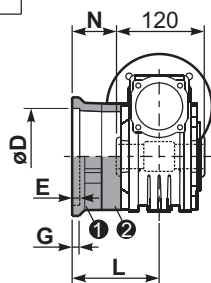

| type B | øD | E | G | L | N | O | P | Q | kit code |
|--------|---------------------------------------|---|----|-----|----|-----|-----|----|------------------------------|
| FC | 115 ^{+0.20} _{+0.15} | 7 | 13 | 86 | 26 | 150 | 175 | 11 | 1 K063.9.010 2 - |
| FL | 115 ^{+0.20} _{+0.15} | 7 | 13 | 116 | 56 | 150 | 175 | 11 | 1 K063.9.010 2 K063.0.200 |
| type S | øD | E | G | L | N | O | P | Q | kit code |
| F1 | 130 ^{+0.20} _{+0.15} | 7 | 13 | 102 | 42 | 165 | 200 | 13 | 1 KS070.9.013 2 - |
| F2 | 115 ^{+0.20} _{+0.15} | 7 | 13 | 116 | 56 | 150 | 175 | 11 | 1 KS063.9.013 2 - |
| F3 | 110 ^{+0.035} ₀ | 5 | 11 | 82 | 22 | 130 | 160 | 10 | 1 KS063.9.011 2 - |

P063BR... Reaction arm
Braccio di reazione

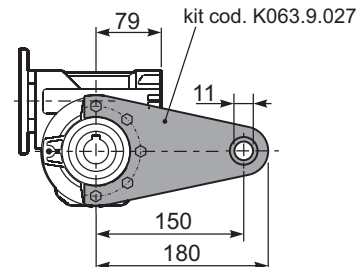
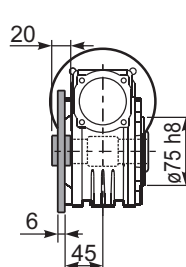

P063.....S... Single Shaft
Albero lento semplice

P063.....D... Double Shaft
Albero lento bisp.

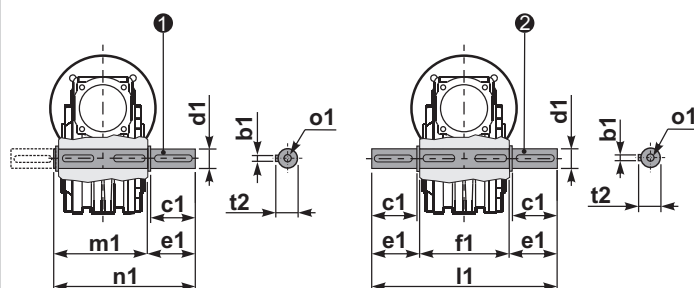

1 kit cod. K063.5.028 type B

2 kit cod. K063.5.029 type B

R063FB... Input shaft
Albero in entrata

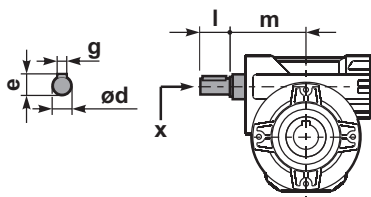

| | ød | e | g | l | m | x | kit code |
|--------|-------|------|---|----|----|-------|--|
| type B | 18 h6 | 20.5 | 6 | 45 | 93 | M6x16 | 1 K063.5.006 PAM80 2 K063.5.007 PAM90 |
| type S | 19 h6 | 21.5 | 6 | 40 | 93 | M8x20 | 1 KS063.5.008 PAM80 2 KS063.5.009 PAM90 |

| | b1 | c1 | d1 | e1 | f1 | l1 | m1 | n1 | t2 | o1 |
|--------|----|----|--|------|-----|-------|-------|-----|----|-------|
| type B | 8 | 60 | 25 ^{-0.005} _{-0.020} | 63.2 | 120 | 246.4 | 126.8 | 190 | 28 | M8x20 |
| type S | - | - | - | - | - | - | - | - | - | - |